

- Notes**
- All dimensions in mm, unless otherwise stated.
  - Scaling from drawing if printed incorrectly may lead to errors.
  - All information outside red line boundary shown for contextual purpose only.
  - All hatch patterns are indicative only unless stated otherwise.
  - This drawing is to be read in conjunction with the following re-form landscape architecture documentation:
    - 0834-RFM-XX-ZZ-DR-L-0005-Planting Plan
    - 0834-RFM-XX-ZZ-DR-L-0007-Kerbs and Edges Plan
    - 0834-RFM-XX-ZZ-DR-L-8001-Paving and Edge Details
    - 0834-RFM-XX-ZZ-DR-L-8002-Step Details
    - 0834-RFM-XX-ZZ-DR-L-8003-Planting Details
    - 0834-RFM-XX-ZZ-DR-L-8004-Mill Dam Wall Details
 AND all relevant documentation from the design team
  - Levels information on this drawing illustrates the design intent. The contractor is to check and verify all levels and dimensions against site survey information.
  - Any discrepancies in the design information are to be brought to the attention of re-form landscape architecture, in writing, prior to commencement of construction works.
  - All proprietary products shall be installed in strict accordance with manufacturers written instructions.
  - Refer to other consultants' drawings and specifications for the following design information:
    - Foundation details
    - Base course and/or sub bases design & specification
    - Waterproofing of any element
    - Levels & Drainage design and infrastructure
    - Lighting and ducting
    - Existing & proposed utilities
  - Fabricator's shop drawings for all timber and metalwork to be submitted for approval prior to fabrication
  - Plant quantities are to suit site areas in accordance with scheduled plant densities.
  - Any proposed plant substitution shall be agreed with the landscape architect prior to ordering.

- Key**
- Planning application boundary
  - Proposed building
  - Proposed building: undercroft car park (Level -01)
  - Proposed tree in soft landscape Refer to drg 0834-RFM-XX-00-DR-L-0005, 8003
  - Proposed grass
  - Proposed shrub planting Refer to 0834-RFM-XX-00DR-L-0005, 8003
  - Proposed raingarden planting Refer to 0834-RFM-XX-00DR-L-0005, 8003 and engineer's drawings
  - Proposed hedge planting Refer to 0834-RFM-XX-00DR-L-0005, 8003
  - Proposed seating Supplier: Vestre, Product: Vroom seat Straight end, 1687mm long, allow 30% of seats with back rests, 90degree corner units, galvanised and powder coated, ebony clear timber
  - Proposed steps Refer to 0834-RFM-XX-00-DR-L-800x Concrete formwork. Clad with Shepley Hill Yorkstone tread and riser by Marshalls with contrasting integral nosing strip in line with BS8300.
  - Proposed seating terraces Refer to 0834-RFM-XX-00-DR-L-800x . Concrete formwork, clad with Naturally Very Durable Hardwood suitable for Service Class 3. 30mm deep slats, untreated
  - Paving to podium Supplier: Hardscape Product: Kellen Cero, Breccia Magma, Dims: 400x400x80mm bands, with 150xvarious(150, 200,300)x80mm between. Laid with 'Drainjoint' to allow water permeability
  - Small unit paving (sets) Supplier: Marshalls Product: Caithness stone (Black mix) Dims: 300x150x50mm, laid staggered bond.
  - Porous bound gravel paths KBI Flexipave, Colour TBC Metal edging along path, Refer to drg 0834-RFM-XX-ZZ-DR-L-8001
  - Tactile corduroy paving to steps Supplier: Marshalls Product: Shepley Hill Yorkstone Dims: 400x400x80mm in line with BS8300. Refer to drg 0834-RFM-XX-00-DR-L-0007
  - Proposed low retaining wall in Caithness stone
  - Handrails to steps and podium Refer to 0834-RFM-XX-00-DR-L-8003 Galvanised and powder coated steelwork with hardwood timber top in line with BS8300. Base plates for posts. mid rail for children.
  - Levels Existing levels retained denoted with (e)
  - Tactile blister paving Supplier: Marshalls Product: Shepley Hill Yorkstone Dims: 400x400x80mm in line with BS8300
  - Proposed kerbs and edges Refer to drg 0834-RFM-XX-00-DR-L-0007

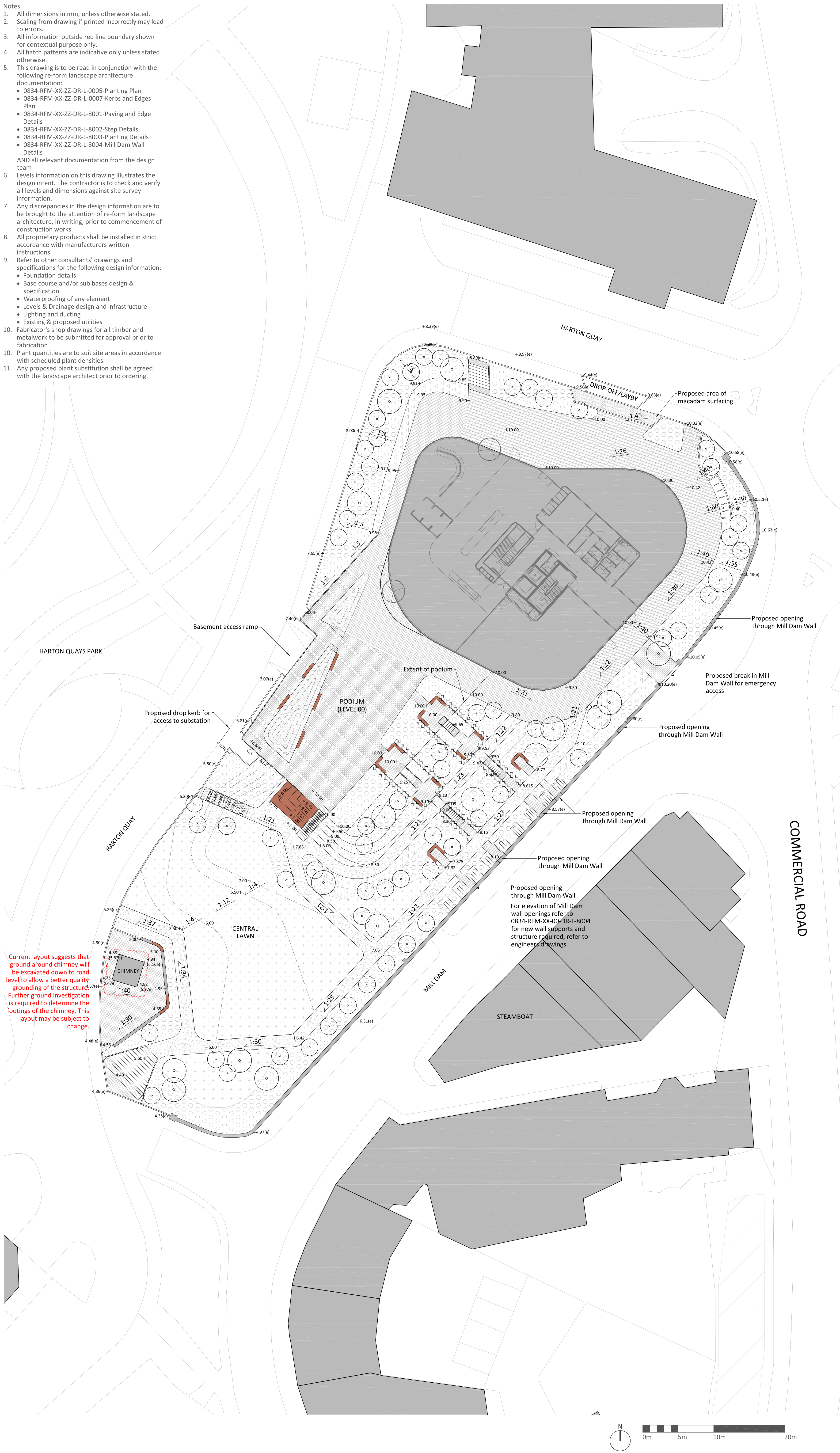

Fabricator's shop drawings for all timber and metalwork to be submitted for approval prior to fabrication

Bedding, sub-base to engineers design.

Date	Description of revision	Drawn	Checked	Approved	Revision
09.03.20	Break created to Mill Dam Wall for fire access	SD	SD	AP	P04
26.02.20	Layout south of substation revised, podium extents reduced to arch layout, planters updated to suit	SD	AP	AP	P03
05.02.20	Spec information added to key, planting to podium increased	SD	AP	AP	P02
03.12.20	Planning	AF	AF	AP	P01

**re-form**  
landscape architecture

Tower Works, Globe Road,  
Leeds LS11 5QG  
T: +44 (0)113 245 4695  
E: info@re-formlandscape.com  
W: re-formlandscape.com

**Project**  
GLASSWORKS, HARTON QUAYS, SOUTH SHIELDS  
RF20-834

**Client**  
MUSE

**Document title**  
LANDSCAPE GENERAL ARRANGEMENT

**Paper size**  
A1

**Scale**  
1:250

**Status**  
FOR INFORMATION

**Revision**  
S2

**Drawing number**  
0834-RFM-XX-ZZ-DR-L-0001

**Revision**  
P04

© re-form landscape architecture

